

# *Classic*

## REVERSIBLE PLOUGHS LX-SX

Setting The Standard





**ovlac**

# OVLAC

## MORE THAN 85 YEARS OF EXPERIENCE

### In tillage equipment

**Ovlac** is a **family-owned company** which has been manufacturing farming equipment since 1936. Since its beginnings, Ovlac has focused its activity in manufacturing mouldboard ploughs, which have been the company's flagship product for decades and still is today.

Over the last 15 years, the **Ovlac** product range has expanded to include other soil working tools such as Cultivators, Chisels and Short Disc Harrows. Today, Ovlac is being run by its third generation and its the biggest Spanish soil working equipment manufacturer.

**Ovlac** exports around 60% of its production to more than 20 countries.

Competitive and demanding markets such as France, Germany and the United Kingdom, or beyond Europe to the likes of Chile, South Africa, New Zealand or China.

Thanks to our state of the art manufacturing techniques, and our in-house R&D department, we can guarantee a high quality throughout our products. **Ovlac** is determined to produce products of the highest quality, this is ingrained into our day-to-day manufacturing processes. Every step and decision taken in our company is carried out to meet our main goal: to offer our clients reliable products they can be proud of.



# RANGE: THE RIGHT MODEL TO FIT YOUR TRACTOR

Ovlac's range of reversible ploughs is made up of 4 Series, 4 Ranges so you can always find the ideal solution to suit your available power and soil conditions.

## SERIES 100

Specially designed for light soils and when weight is a limiting factor. Main frame of 110 by 110 mm square profile section and 100 mm headstock shaft. Ploughs from 2 to 4 furrows. Rated up to maximum power of 27,5 HP [20 kW] per body.

## SERIES 120

This series is also limited to 4 furrows, although in this case the main frame is 100 by 150 mm and the headstock shaft is increased to a diameter of 110 mm. This structure is rated up to maximum power of 160 HP [120 kW].

## SERIES 130

Featuring a substantial **140 mm diameter** headstock shaft. This series is available in a four or five furrow configuration, and is rated up to 200 HP [150 kW]. At the same time, it keeps the 100 by 150 mm frame section of the 120 Series to stay light.

## SERIES 150

**Higher Strength** available as 4 and 5 furrow configurations designed for arduous conditions and higher horse power. Rated up to 225 HP [165 kW]. 150 by 150 mm frame section and reinforced headstock with a 140 mm shaft diameter.



headstock 100



headstock 120



headstock 130



headstock 150

SERIE  
100



Headstock 100 + Frame support  
100 + 110\*110 mm frame section.

SERIE  
120



Headstock 120 + Frame support 120  
+ 150\*100 mm frame section.

SERIE  
130



Headstock 130 + frame support 130  
+ 150\*100 mm frame section.

SERIE  
150



Headstock 150 + frame support 150  
+ 150\*150 mm frame section.



# PROTECTION SYSTEMS

## Shearbolt and hydraulic

Taking into account working conditions, OVLAC ploughs can be equipped with two different protection systems.

### SHEAR-BOLT SECURITY SYSTEM:

The simplest of all two. The shear bolt thickness, steel grade and position are calculated so it breaks under a pressure of approx. 3000 kg exerted at the point. It is highly recommended that broken shear bolts be replaced by genuine ones; a non-genuine shear bolt, bearing a different dimension or steel grade, can result in serious damage to the main plough frame for not correctly accomplishing its task.

### HYDRAULIC NON-STOP SYSTEM:

Regulated trip mechanism. It allows for adapting **release pressure according to soil conditions**. In heavy or compacted soil, pressure can be increased in order to guarantee penetration and maintain an optimal working position of the bodies. On the contrary, under stony conditions pressure can be set lower in order not to bring stones onto the surface.

In addition, the frog legs are also bolted on to the beam, and not welded thus benefitting from **dual security**.

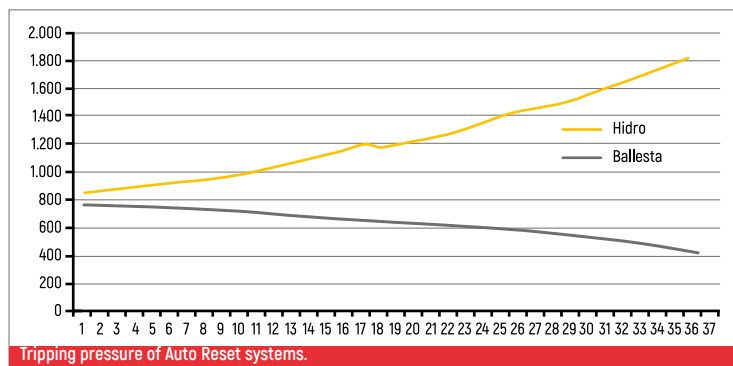

Shearbolt



Hydraulic



# VARIABLE WORKING WIDTH

## "L" model - "S" model

Working width adjustment is available in all Ovlac ploughs in order to adapt the plough to soil conditions or the desired work.

Working width of all **"L" models** (LV, LVH, LF, and LH) can be manually adjusted by simply shifting positions of the support bolt into a different hole on the beam. There are **four different working widths with 2 inch increment adjustments**.

All **"S" style ploughs** (SF, and SH) come with the well known **Ovlac Varilabor** variable working width as standard. Working width can be **hydraulically operated from the tractor cab** between 12 and 20 inches per body (can slightly change depending on different models).

This feature provides several advantages:

- **Optimized output**, making the most of the tractor power.
- **Adaptation to desired work** in terms of working depth, soil type, crop types and seasons.
- **Adaptation to ploughing plot individualities:** Topography and obstructions.

**Automatic Memory System:** The complete range of Ovlac reversible ploughs in 5 and 6 furrows comes as standard with an automatic memory system which withdraws the plough main frame to its minimum width so as **to guarantee a gentle turning over** and avoid that the rear end of the plough hits the ground. Once this operation is done, the plough automatically returns to the originally set working width.



"L" Model



"S" Model









# WHAT MAKES US UNIQUE

## Oscillating drawbar. Automatic self-alignment

**Ovlac Classic ploughs** are equipped with the Oscillating Hitch, which makes it possible for the **plough to move freely from a central pivoting point** in the cross-shaft and to find by itself the perfect balance between the side pressure exerted on the mouldboard and the landside. Therefore there is no need for complicated adjustments on the pull line so as to make the plough work perfectly aligned. **Alignment is automatically corrected** with no need of any operation by the driver.

In the **Hydraulic Vari width ploughs** (SF, SH) the Oscillating Hitch makes it possible for the plough to adjust itself to the new pressure balance resulting from modifying the working width, correcting automatically and immediately the plough alignment, with no effort required by the operator. It can't be simpler.

When lifting the plough up for transport or turning over, the Oscillating Hitch **will automatically lock** itself preventing the plough from balancing sideways.

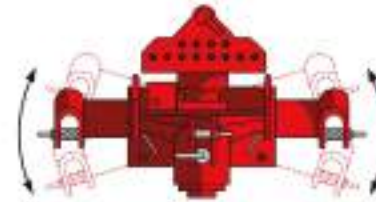

Oscillating Drawbar in action

Other ploughs



Ovlac ploughs



# OTHER STRONG POINTS

## Non Stop, Vario and Main Beam

### 1- LONG LIFE TO VARIO

In **hydraulic vari width models** ("S"), **body supports are bolted** onto the frame; thus, in the case of an unlikely breakdown, these supports are easily replaceable. Furthermore, the pivoting points of these supports are located away from the main frame, this way the frame is **not weakened or subject to any wear**. These pivoting points are equipped with wear resistant case-hardened bushes and greasing points in order to ensure a long lifespan.

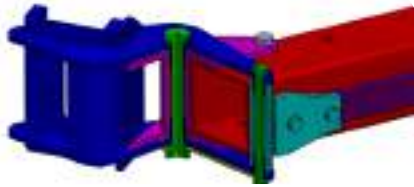

### 2- NON STOP PLOUGHS FOR THE HARDEST CONDITIONS

In **Non Stop ploughs**, frog beams/legs are bolted instead of welded. One of the fixing bolts is specifically designed as a shear bolt, which results in an **extra security** to be added to the Non Stop. The Articulated Security Rod linking the leg holder to the main frame has been designed to withstand the most rigorous conditions. Its articulated system results in a genuine 3D security system.



### 3- EXPERIENCE AND MODERNITY

**Ovlac** has over 85 years of experience in the manufacturing of ploughs. This practical knowledge is supplemented up by the efforts of a young team of capable engineers using the latest design, development and production techniques in order to attain the perfect combination of experience and modernity.



### 4-SUBSTANTIAL, SIMPLE AND RELIABLE MAIN BEAM

The main beam is made in high quality "Domex" Swedish steel and is **100% free from welding** - therefore tension and weak spots are eliminated. Furthermore, at the front of the beam where the load and stress are highest the frame is reinforced with "**Hardox sandwich plates**".



### 5- IMPROVED LEG CLEARANCE

The straighter leg design increases clearance between furrows to allow more trash and soil through without blockages. Ovlac 95cm ploughs have more clearance than other ploughs with 100cm spacing.



# BODIES

## Range of 5 plough bodies

**Ovlac** has five different plough bodies in order to offer the most suitable option for a specific ploughing technique and soil. All genuine **Ovlac mouldboards** (with the exception of the slatted and plastic boards) are made in 8 mm thickness and undergo a unique Case - Hardening process in order to achieve over HRC 62 on their surface while still offering a soft core. Apart from guaranteeing a long lifespan of the mouldboard, case-hardening also results in less sticking and better soil flow.



Case-hardening allows for higher hardness on surface, more than 62 HRC, while keeping a soft, flexible core.



**V-34:** all-purpose body for all types of soil. Well suited for wide tires. Good soil turning with limited tractor power requirements. For depths between 15 and 35 cm.



**V-97:** all-purpose body for all soil types. Very low tractor power requirement. Working depth between 15 and 30 cm.



**V-PLAST:** recommended for very sticky soils with no stones. Same geometry as V-34 body.



**V-LOV:** mouldboard with slats. Suitable for sticky soils. All wearing parts mounted with conical bolts in order to lengthen lifespan, specially of slats.



**V-90:** leaves a wide furrow; specially recommended for very wide tractor tyres (>760 mm). Very good soil turning thanks to its extra length. Similar power requirement to body V-97.

# OPTIONS

## A wide range of accessories

A wide range of accessories is available in order to adapt the plough to any working type and soil.



Trashboard.

GRASS SKIMMER



HIGH CAPACITY SKIMMER



Grass and High Capacity skimmers. It is important that Skimmers are correctly set in height. That is why we have designed them so no tools are needed to this end.



Smooth or scalloped disc coulters.



Spring reset protected smooth or scalloped disc coulters.



Tailpress.



Knife Coulter.



Landslide wear plate.



X-Light beam, 25kg lighter than standard (**Max: 32hp per body**).



Lights.



Oscillating shaft with shock absorption.

# WHEELS

A large range to meet your needs

**Ovlac reversible ploughs** can be fitted with a wide range of wheels. We have the perfect wheel for every need.

Depending on their **function**, there are depth control wheels and versatile control and transport wheels.

A **rear-positioned wheel** ensures optimal plough balance and greater weight transfer to the tractor during operation.

Finally, different **wheel sizes** are available depending on the plough's weight and the terrain conditions.



Rear control wheel  
200/60 14,5"



Rear control and transport wheel  
340/55 16"



Hydraulic rear control wheel  
280/70 16"



Wheel 6.00 x 9" 10PR



Wheel 200/60 14.5" 10PR



Wheel 250/65 14.5" 12PR



Wheel 340/50 16" 18PR



Wheel 280/70 16" R16

# TECHNICAL FEATURES

**S** Shearbolt **H** Hydraulic

N° of bodies		3		4		5	
		S	H	S	H	S	H
SERIE 100	Working width (LV/LVH)	105-150		140-200			
	Inter body clearance (cm)	85 95 105	85 95	85 95			
	Under beam clearance (cm)	72 78		72 78		----	
	Weight (LV/LVH)	890	1020	1110	1250		
	Max. Power (HP)	75-85		90-110			
SERIE 120	Working width (LV/LVH)	105-150 / 90-150		140-200 / 120-200			
	Inter body clearance (cm)	85 95 105		85 95 105	85 95		
	Under beam clearance (cm)	72 78 90	72 78	72 78		----	
	Weight (LV/LVH)	1080/1140	1130/1300	1305/1385	1550/1630		
	Max. Power (HP)	90-120		120-160			
SERIE 130	Working width (LV/LVH)			140-200 / 120-200		175-250 / 150-250	
	Inter body clearance (cm)			85 95 105		85 95	
	Under beam clearance (cm)	----		72 78 90	72 78	72 78	
	Weight (LV/LVH)			1365/1445	1580/1660	1620/1720	1860/1970
	Max. Power (HP)			120-160		150-200	
SERIE 150	Working width (LV/LVH)			140-200 / 120-200		175-250 / 150-250	
	Inter body clearance (cm)			85 95 105	85 95	85 95 105	85 95
	Under beam clearance (cm)	----		72 78 90	72 78 90	72 78	
	Weight (LV/LVH)			1495/1575	1670/1750	1765/1865	1960/2060
	Max. Power (HP)			120-180		150-225	





## A SOLUTION FOR ANY FIELD



Ploughs



Trailed Ploughs



Minichisel - XLander



Versatill



Maxidisc



Eurodisc



Minichisel Vineyard



Reptill



Polígono Industrial, P-163 / 165 - 34200 - Venta de Baños  
Palencia / Spain - Tel: **+34 979 76 10 11**  
comercial@ovlac.com - [www.ovlac.com](http://www.ovlac.com)

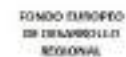

COMUNIDAD