



A Passion for Soil

XPerience

REVERSIBLE PLOUGHS

Smart Ploughing





OVLAC

MORE THAN 85 YEARS OF EXPERIENCE

In tillage equipment

Ovlac is a **family-owned company** which has been manufacturing farming equipment **since 1936**. From the beginning, **Ovlac** has focused its activity around manufacturing **mouldboard ploughs**, which have been the company's flagship product for decades.

Today, Ovlac is run by the family's third generation and is **the largest Spanish tillage equipment manufacturer**.

Ovlac exports around 60% of its production to more than **20 countries around the world** including demanding markets such as France, Germany and the United Kingdom and **beyond Europe** to Chile, South Africa, New Zealand and China.

Thanks to its **state of the art manufacturing techniques**, and **in-house R&D department**, Ovlac can guarantee high quality throughout its product ranges. **Ovlac's** high standards are also ingrained into its day- to-day manufacturing processes.

Every step and decision taken at Ovlac is carried out to meet a key goal: to offer farmers technically advanced, reliable products they can be proud of.



RANGE: THE RIGHT MODEL TO FIT YOUR TRACTOR

Ovlac's range of **XPerience** reversible ploughs is made up of 3 series, 3 ranges, so you can always find the ideal solution to suit your available power and soil conditions.

SERIES 130

Featuring a substantial 140 mm diameter headstock shaft. This series is available in a 4 or 5 furrow configuration, and is rated up to 200 HP (150 kW). At the same time, it keeps the 100 by 150 mm frame section of the 120 Series to stay light.



Headstock 130.

SERIES 150

Higher strength available as 4 and 5 furrow configurations designed for arduous conditions and higher horse power. Rated up to 225 HP (165 kW). 150 by 150 mm frame section and reinforced headstock with a 140 mm turnover shaft.

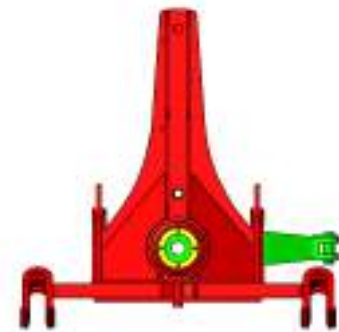

Headstock 150/180.

SERIES 180

The pinnacle of the mounted range available as 5, 6 and 7 furrow configurations. With a superstructure design consisting of 150 by 150 mm frame section, heat treated 140 mm headstock, substantial reinforced Hardox supports and larger turnover ram. This range topping mounted plough is capable of remarkably high work rates. Rated up to 300 HP (220 kW).



**SERIES
130**

Headstock 130 + frame support 130
+ frame section 150*100.

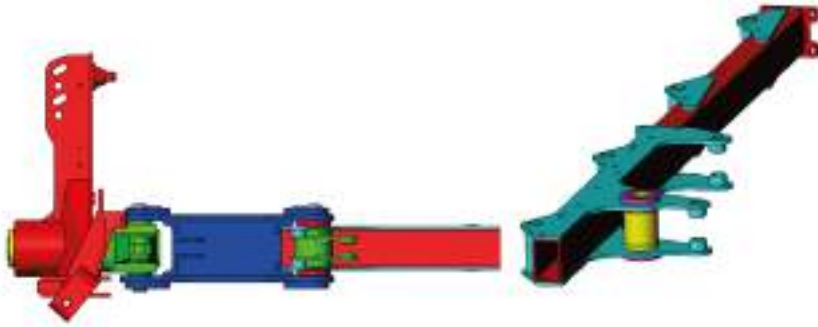

**SERIES
150**

Headstock 150 + frame support 150
+ frame section 150*150.

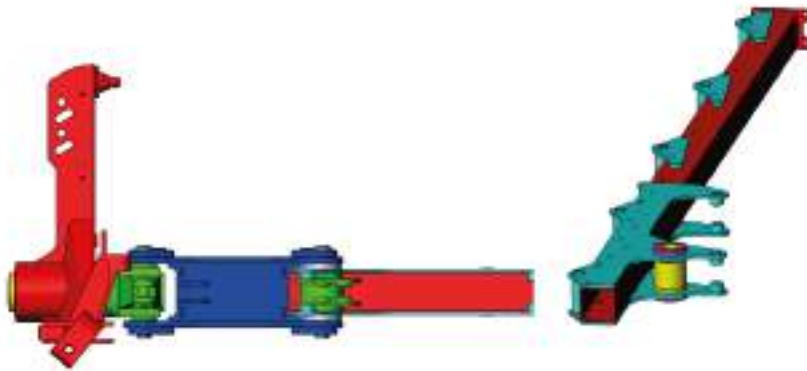

**SERIES
180**

Headstock 180 + frame support 180
+ frame section 150*150.

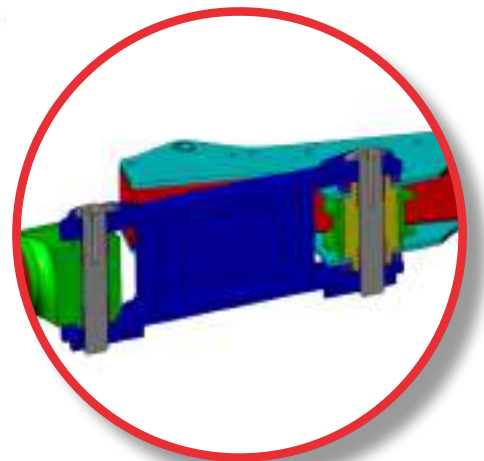
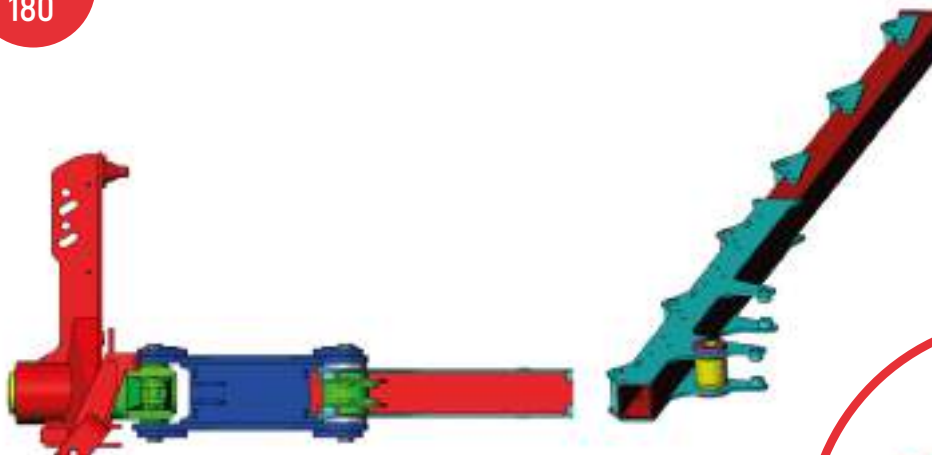

PROTECTION SYSTEMS

Shearbolt or hydraulic reset

Taking into account working conditions, **Ovlac XPerience** ploughs can be equipped with two different protection systems.

SHEARBOLT SECURITY SYSTEM:

The simplest of all two. The shear bolt thickness, steel grade and position are calculated so it breaks under a pressure of approx. 3000 kg exerted at the point.

It is imperative that broken shear bolts be replaced by genuine ones. A non-genuine shear bolt, bearing a different dimension or steel grade can result in serious damage to the plough.

NON-STOP HYDRAULIC RESET SYSTEM:

A regulated trip mechanism. It allows adaptation of release pressure according to soil conditions. In heavy or compacted soil, pressure can be increased in order to guarantee penetration and maintain an optimal working position of the bodies.

On the contrary, under stony conditions pressure can be set lower in order not to bring stones to the surface. Frog legs are also bolted on to the beam, and not welded thus benefitting from dual security.

Shearbolt



Hydraulic Reset



VARIABLE WORKING WIDTH

"XP" Model - "XP-V" Model

Working width adjustment is available in all **Ovlac XPerience** ploughs in order to adapt the plough to soil conditions or the desired work.

The working width of all **"XP" models** (XPF y XPH) can be manually adjusted by simply shifting positions of the support bolt into a different hole on the beam. There are **four different working widths with 2 inch increment adjustments**.

All **"XP-V" models** (XPFV y XPHV) come with the well known Ovlac Varilabor variable working width as standard. Working width can be **hydraulically operated from the tractor cab** between 12 and 20 inches per body (can slightly change depending on different models).

This feature provides several advantages:

- **Optimized output**, making the most out of the tractor power.
- **Adaptation to desired work** in terms of working depth, soil type, crop types and seasons.
- **Adaptation to ploughing plot individualities:** topography and obstructions.

Automatic Memory System: the complete range of **Ovlac XPerience** reversible ploughs in 5 and 6 furrows comes as standard with an automatic memory system which closes the plough main frame to its minimum width so as **to guarantee a gentle turn over** and avoid that the rear end of the plough hitting the ground. Once this operation is done, the plough automatically returns to the originally set working width.

"XP" Models



"XP-V" Models



WHAT MAKES THE XPERIENCE UNIQUE

Oscillating cross shaft - automatic self-alignment

Ovlac XPerience ploughs are equipped with an Oscillating Cross Shaft with a centre pivot. The plough is pulled from the centre pivot point which ensures it can move independently to follow the tractor and find the perfect balance between the side pressure exerted on the mouldboard and the landslide.

Therefore once the plough is set correctly it is not necessary to make complicated adjustments in order to ensure the plough pulls straight. In work the plough will follow the tractor perfectly.

Alignment is corrected with no need for operator input. Furthermore with the Hydraulic Vari width ploughs the Oscillating Cross Shaft automatically compensates for working width adjustment. It could not be simpler.

When lifting the plough for transport or turn over, the Oscillating Cross Shaft **automatically locks** itself in the central position.

The cross shaft movement also makes it very easy to hitch up to the plough.

In addition to the operational benefits the Oscillating Cross Shaft **significantly reduces strain on the whole plough and fuel usage.**



The Oscillating Cross Shaft allows the operator to plough around headlands and irregular shaped fields which increases daily output.

Other ploughs

Ovlac Ploughs

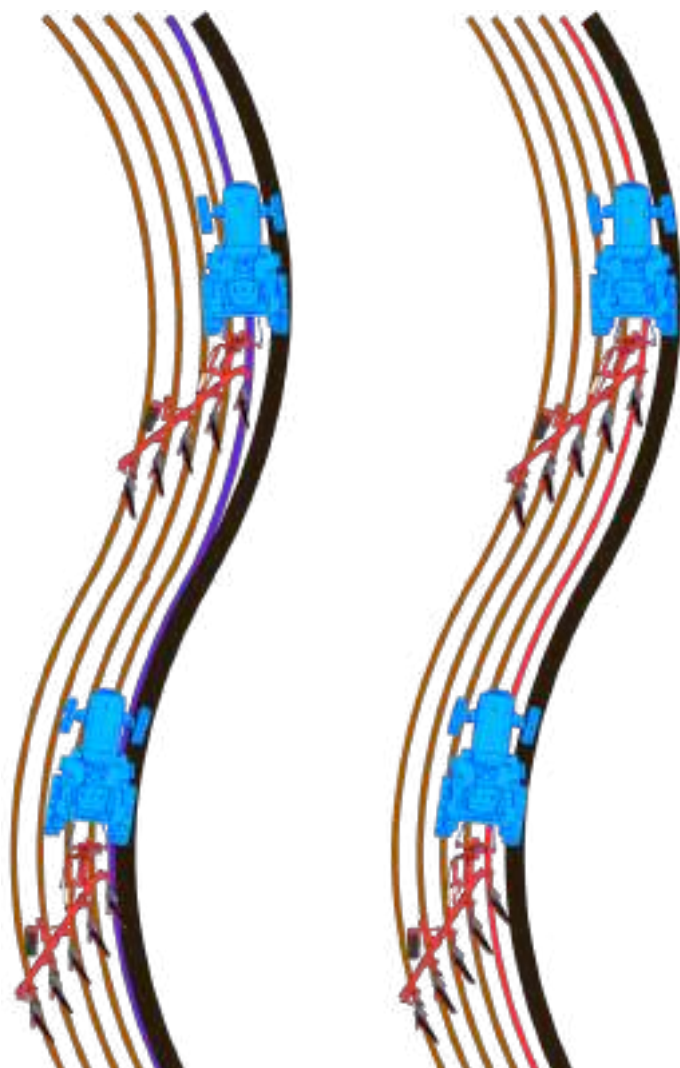

Oscillating drawbar in action

OTHER STRONG OPTIONS

Frames, Non Stop systems, Vari width

1 - PARALLELOGRAM BEAM LINKAGE

Parallel beam alignment linkage combined with the Oscillating Cross Shaft mean Xperience ploughs offer true on-the-move vari width. No additional adjustment equired.



2- LONGEVITY DESIGNED IN

On Hydraulic Vari width models (XPV), the Hardox 500 legs are bolted onto the frame. Therefore if the worst happens, and one is damaged it can easily be replaced. In addition, the leg pivot points are not part of the main frame, so the frame is not weakened or subject to any wear.

The pivot points are also equipped with wear resistant casehardened bushes and greasing points to ensure a long life.

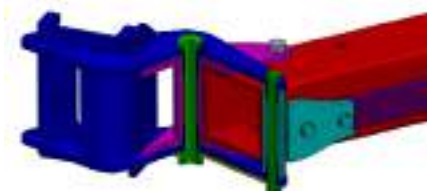

3- NON STOP PLOUGHS FOR THE HARDEST CONDITIONS

The 3D articulated Security Rod linking the leg holder to the main frame has been designed to withstand the most rigorous conditions. It provides protection from sideways and vertical force as well as enabling break-back.



4- IMPROVED LEG CLEARANCE

The straighter leg design increases clearance between furrows to allow more trash and soil through without blockages. Ovlac 95cm ploughs have more clearance than other ploughs with 100cm spacing.



XPERIENCE ON-LAND

The On land version of the best plough

XPerience On-Land (XP-OL) is the next step in the evolution of the XP design, adapted to work both in-the-furrow or on-land. This is the result of several years of research, since the launch of the first XP, as well as incorporation of Ovlac's expertise in the design of soil working equipment.

The most significant change on the **XP-OL** model is an oversized **parallelogram with 2 cylinders**.

The first of these cylinders controls the width of the first body (in-the-furrow or on-land), as well as closing in the plough for gentle, trouble-free turn over. The second cylinder controls the working width.

Changing position from in-the-furrow to on-land is as simple as opening or closing a valve, with no need for any tools.

Working on-land is necessary with large tractors, dual wheels or wide tyres. Thus the **XP-OL** is designed to work with **tractors up to 3.2m wide**.

Another very important point to consider is the ability to **work with GPS auto-steering systems**.

Agronomically, working on-land has a series of advantages, **such as less compaction at the bottom of the furrow, and improving traction which reduces fuel consumption and CO2 emissions**.



TECHNICAL FEATURES

S Shearbolt

H Hydraulic

	N° of bodies	4-EXT		5		5-EXT		5-EXT-OL		6		6-OL		6+1-OL	
		S	H	S	H	S	H	S	H	S	H	S	H	S	H
SERIES 130	Working width (XP/XPV)	140-200 / 120/200		175-250 / 150-250											
	Interbody clearance (cm)	85 95 105	85 95	85 95 105	85 95										
	Under beam clearance (cm)	72 78 90	72 78	72 78											
	Weight (XP/XPV)	1585 1665	1680 1760	1755 1855	1915 2015										
	Power (HP)	120-160		150-200											
SERIES 150	Working width (XP/XPV)	140-200 / 120/200		175-250 / 150-250											
	Interbody clearance (cm)	85 95 105	85 95	85 95 105	85 95										
	Under beam clearance (cm)	72 78	72 78	72 78											
	Weight (XP/XPV)	1670 1750	1795 1875	1850 1950	2050 2150										
	Power (HP)	120-180		150-225											
SERIES 180	Working width (XP/XPV)					175-250 / 150-250		175-250 / 150-255		210-300 / 180-300		210-300 / 180-306		245-350 / 210-350	
	Interbody clearance (cm)					85 95 105	85 95 105	85 95	85 95	85 95	85 95	85 95	85 95	85 95	
	Under beam clearance (cm)					72 78 90	72 78	72 78		72 78		72 78		72 78	
	Weight (XP/XPV)					1860 1960	2150 2250	2050 2150	2340 2440	2040 2160	2405 2525	2230 2350	2595 2715	2580 2700	
	Power (HP)					150-250		175-250		180-300		210-300		245-350	

Vario	Mechanic	Hydraulic	Mechanic	Hydraulic
180 CV	XPF 130	XPVF 130	XPVH 130	XPVH 130
225 CV	XPF 150	XPVF 150	XPVH 150	XPVH 150
285 CV	XPF 180	XPVF 180	XPVH 180	XPVH 180

BODIES

Range of 5 plough bodies

Ovlac offers five different plough bodies which enable the most suitable option for a specific ploughing technique and soil type to be selected. All genuine Ovlac mouldboards (with the exception of the slatted and plastic boards) are 8mm thick and undergo a **unique Case-Hardening process** in order to **achieve over HRC 62 on the surface** while still offering a soft core to prevent breakage. In addition to guaranteeing a long wearing life for the mouldboard the smooth surface produced by the case-hardening process improves soil flow and reduces sticking.



8mm thick mouldboards - longer working life.

Case-hardening increases surface hardness, (more than 62 HRC) for a longer working life while keeping a soft, flexible core.



V-34: All-purpose body for all soil types. Soil inversion with limited tractor power requirement. For depths between 15 and 35cm.



V-97: All-purpose body for all soil types. Designed for very low tractor power. Working depth between 15 and 30cm.



V-LOV: Slatted mouldboard. Suitable for sticky soils. All wearing parts mounted with conical bolts to lengthen the slat and bolt lifespan.



V-90: Leaves a wide furrow; recommended for very wide tractor tyres (760 mm). Very good soil inversion thanks to its extra length. Similar power requirement to body V-97.



V-PLAST: Recommended for very sticky soils with no stones. Same geometry as V-34 or V-90 bodies.

OPTIONS

Wide range of accesories

A wide range of accessories are available in order to adapt the plough to all soil types and working conditions.



Trashboard

GRASS SKIMMER



HIGH CAPACITY SKIMMER



Two skim mouldboards available: Grass and High Capacity. It is important that Skimmers are correctly set in height. That is why we have designed them so no tools are needed for this.



Spring reset protected smooth or scalloped disc coulters



Smooth or scalloped disc coulters



Tailpress



Knife Coulters



Landslide wear plate



X-Light beam, 25kg lighter than standard (Max: 32hp per body)



Hydraulic front furrow width adjustment



Lights

WHEELS

A large range to meet your needs

Ovlac XPerience reversible ploughs can be equipped with a number of different wheel types.

There are **Depth Control Wheels or Combi Wheels**, for depth control and transport. In terms of position Ovlac provide either Rear or Advanced Wheels.

Rear Wheels ensure optimal plough balance as well as better weight transfer to the tractor whilst ploughing.

Advanced Wheels are advisable when trying to get closer to field boundaries and obstacles, they also result in less strain on tractor arms when in transport and during turn over as the centre of the gravity is closer to the tractor.



Rear control wheel 200/60 14,5"



Hydraulic rear control wheel 280/70 16"



Rear control and transport wheel 340/16"



Advanced control wheel 250/65 14,5"



Advanced control and transport wheel 340/55 16"



Advanced hydraulic transport and control wheel 340/55 16"



The front wheels are brought forward to lie completely within the width of the frame.

OTHER PRODUCTS

In the Ovlac range

CONVENTIONAL PLOUGHS



SEMI-MOUNTED PLOUGHS



MINI



MINI N



MINI S



MINICHISEL VINEYARD



XLANDER



VERSATILL



HC LINE



MAXIDISC II



EURODISC



MINIVID



REPTILL



A SOLUTION FOR ANY FIELD



Polígono Industrial, C/ TAF, P163
34200 - Venta de Baños
Palencia - Spain



+34 979 76 10 11



comercial@ovlac.com



www.ovlac.com

